



● Thank you for purchasing our product. Before installing/operating the product, read the instructions carefully and retain them for future reference.

⚠ Attention!

- For installation, follow the steps described. Any damage caused by wrong installation shall be imputed to the users.
- To avoid a short circuit from occurring do not pull or modify the wires during installation.
- Do not disassemble or change any parts. Opening and disassembling this unit will void any warranty.
- Maintenance and repairs should be executed by our professionals only.

⊙ Symbol description:

NOTE

⚠ Some procedures must be followed to avoid damages to the instrument.

⚠ **WARNING!** Certain procedure must be followed to avoid damages to yourself, to the vehicle to others.

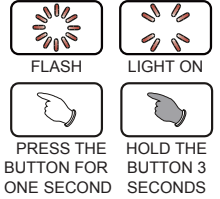

1-1 Accessories

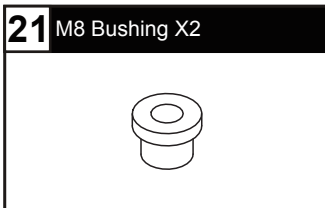
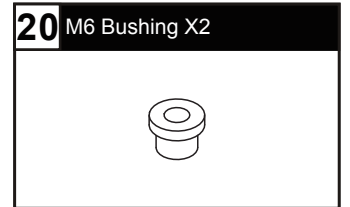
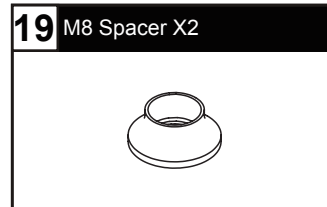
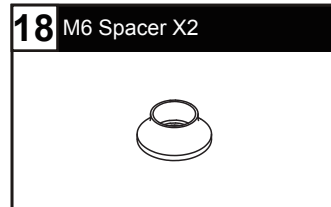
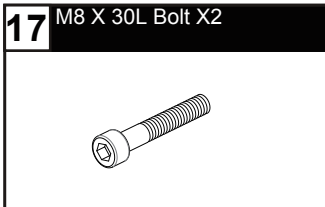
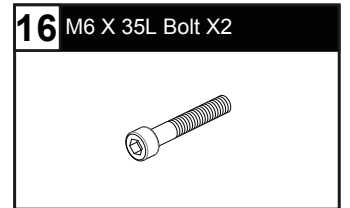
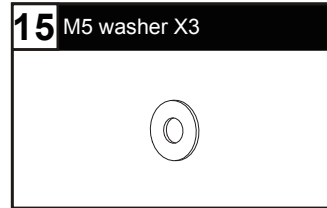
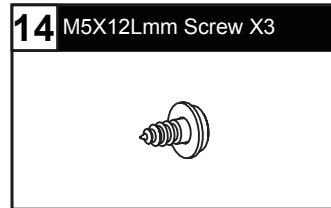
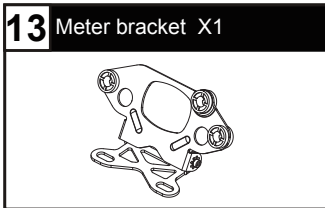
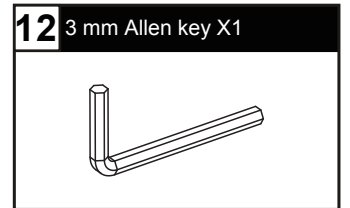
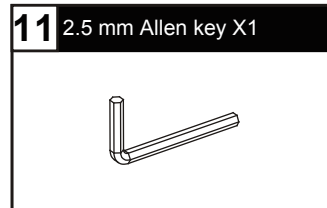
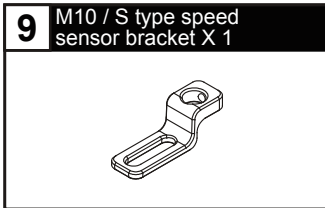
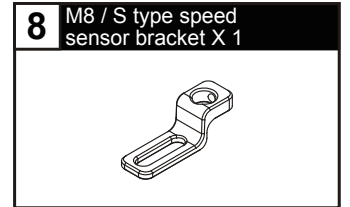
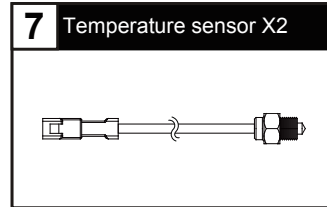
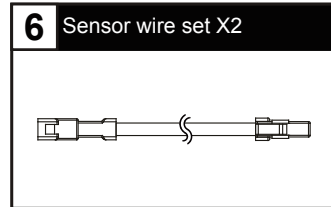
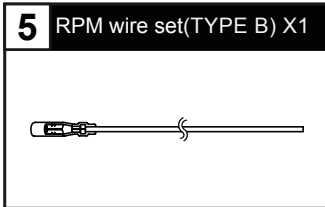
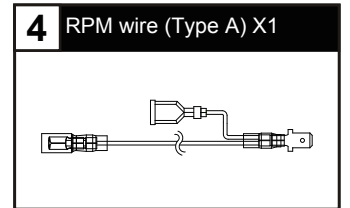
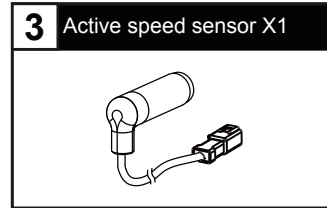
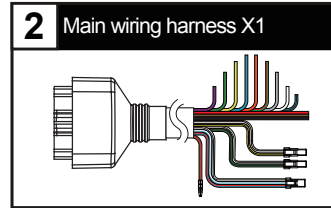
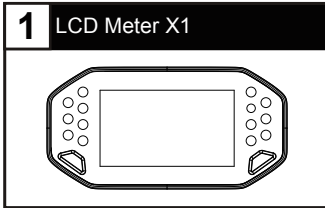

1-2 Optinal accessories

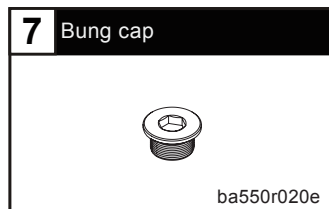
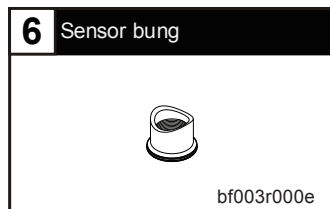
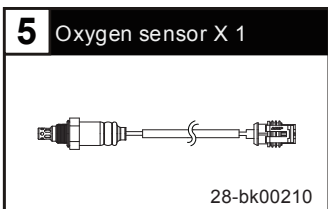
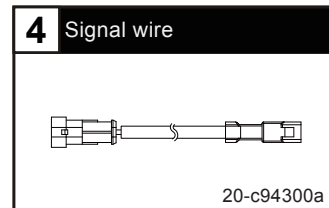
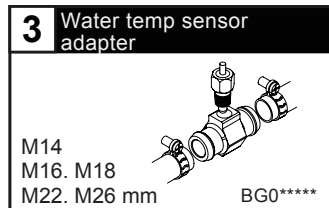
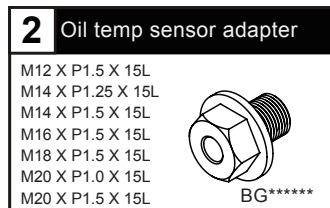
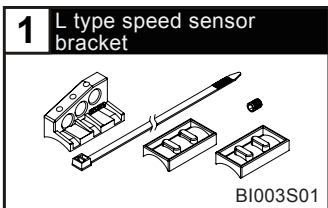

NOTE Some of the option accessories may be purchased separately. For more details, contact your local distributor.

2-1 Wiring Installation Instructions

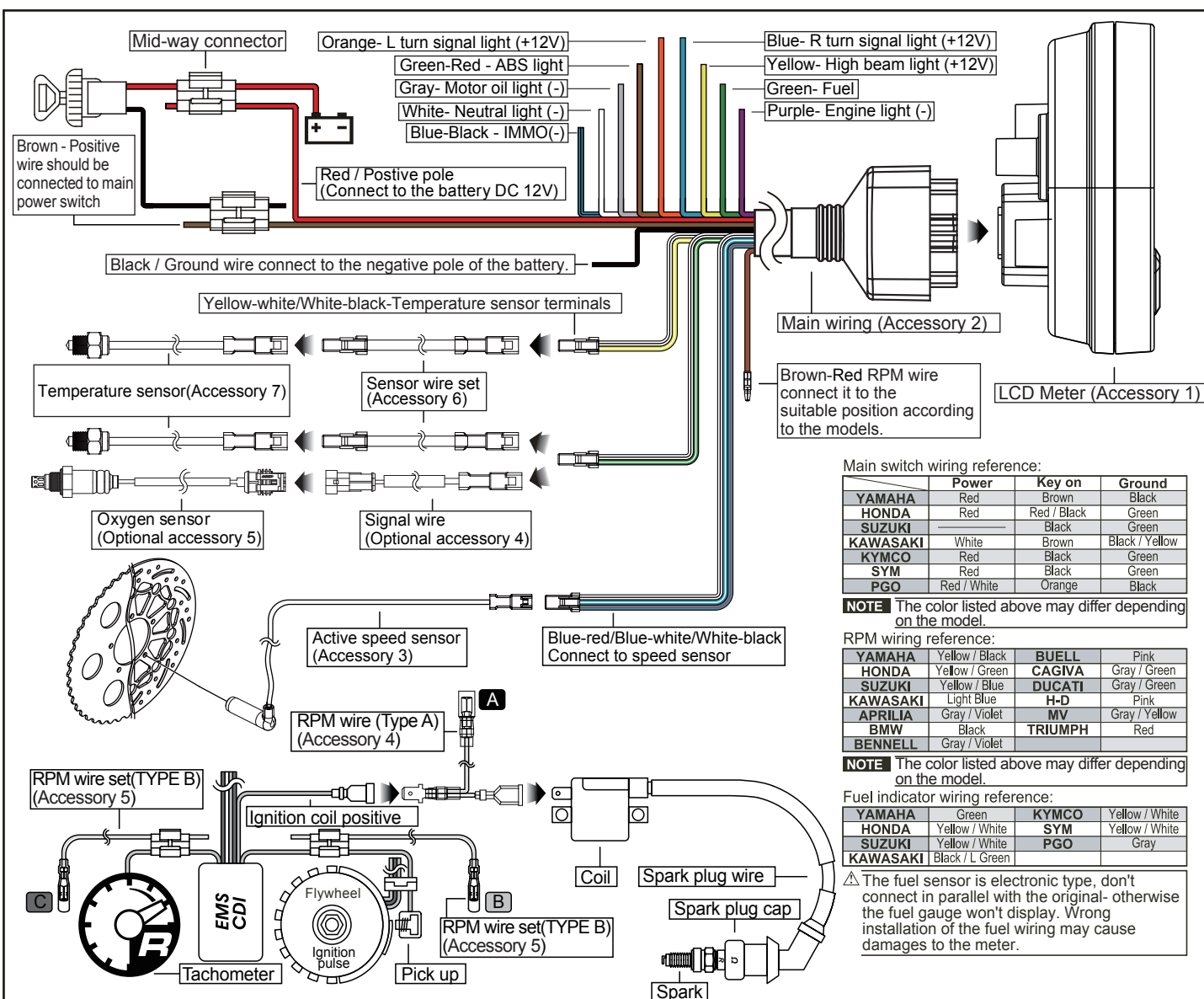

NOTE When connecting the power wire, follow the instructions carefully. If the red & brown wires are connected in parallel, the meter won't work properly.

⚠ The RPM wire installation

We recommend installing the R type spark plug or low-resistance spark plug cap at the same time.

A. Connect the RPM wire (Type A) on the spark plug wire by connecting the male and female connectors.

B. Connect the RPM wire (Type B) to the pick up sensor.

C. Connect in parallel the RPM wire (Type A) with the original tachometer signal wire.

The best signal source will be in order as C>B>A, we will suggest that you check different ways if you have problems getting the RPM signal.

2-2 Installation instructions

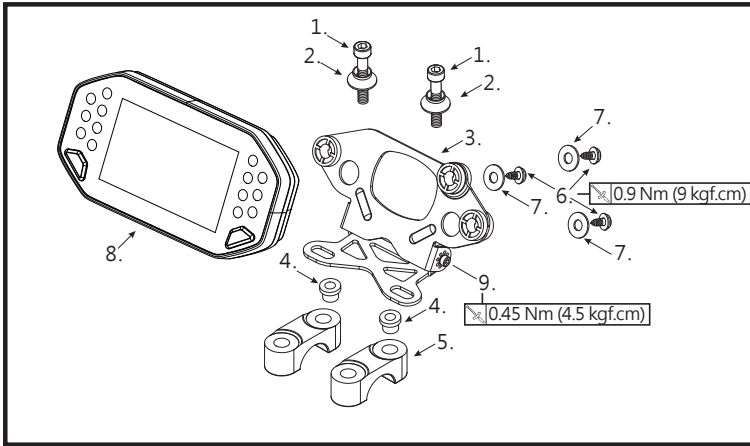

Follow the steps below during installation.

1. M6 or M8 Bolt X2 (Accessory 16,17)
2. M6 or M8 Spacer X2 (Accessory 18,19)
3. Meter bracket (Accessory 13)
4. M6 or M8 Bushing X2 (Accessory 20,21)
5. Handlebar bracket

NOTE You can also install it (meter bracket) on the original meter bracket.

6. M5 screw X 3 (Accessory 14)
7. M5 washer X3 (Accessory15)
8. LCD Meter (Accessory1)
9. Meter bracket micro-adjustment screw

NOTE You can choose the angle first and then use the screw to fix the angle.

NOTE The handle bar bracket screw and screw hole will differ depending on the model. We suggest you to use the additional assembly (item 1.2.4) to fit it.

2-3 Oxygen Sensor Installation

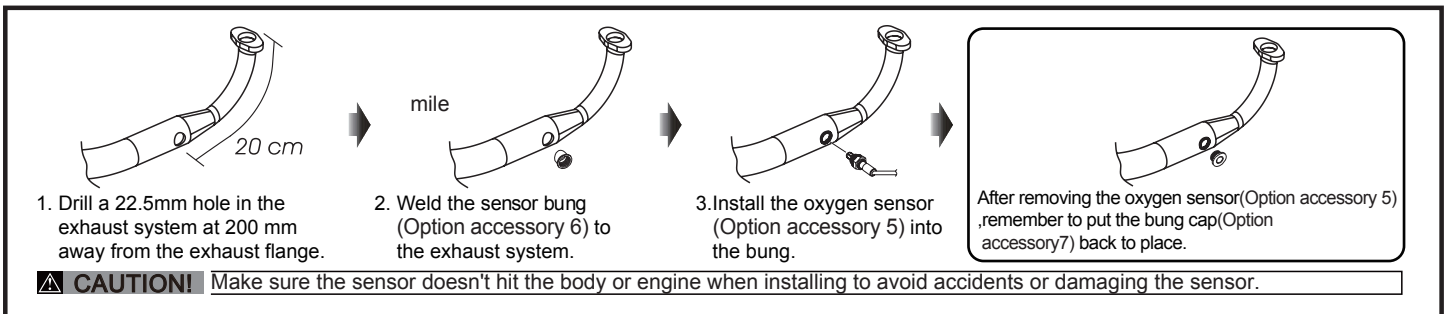

MOTO / SCOOTER S type speed sensor bracket instruction



Install the S type sensor bracket.

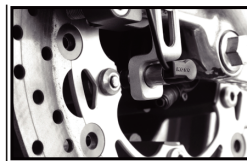

Install the speed sensor on the bracket.

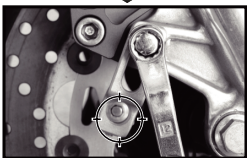

Adjust the sensor bracket position to make sure that the sensor faces the magnet to prevent bad speed signal or no signal!



Adjust the distance between sensor and magnet. We suggest you make sure the distance is under 1 mm for an optimal speed signal.

MOTO / SCOOTER L type speed sensor bracket instruction



Install the L bracket and the anti-slip rubber on the front fork and adjust it to the proper height and angle.



Install the speed sensor into the proper hole on the bracket.

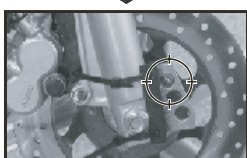

Use the zip tie to fix the bracket on the front fork. Make sure the disc screw could pass the hole on the bracket for you to install the sensor into the same hole for catching the speed signal.

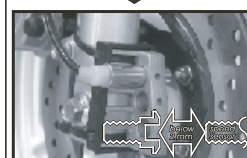

Adjusting the distance between the sensor and screw to get the best speed signal. Make sure the distance is under 2mm to get the best signal.



The active speed sensor needs to be facing a metal surface to detect the speed.

EX. 1 The disc screw.

EX. 2 The disc to detect the disc gap. (Make sure the distances between the gaps are the same in advance to avoid improper speed signal.)

EX. 3 The sprocket to detect the disc gap. (Make sure the distances between the gaps are the same in advance to avoid improper speed signal.)

EX. 4 Rear disc - detect the gap between the disc.

We suggest you obtain the speed from the disc screws. The more sensor points are, the better the speed accuracy is. The maximum sensor points the speed sensor could detect is 40 points per turn.

⚠ After installation, use your hand to turn the tire to see if everything is ok. The LED on the active speed sensor will light up once the signal is detected.

EX. 1

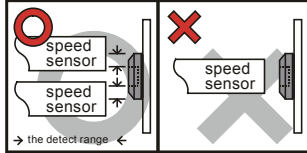

The hexagon socket disc screw
The best detection area: The edge of the hexagon socket screw.

⚠ Don't pick-up the signal from the middle hole of the hexagon socket screw to avoid wrong signal.

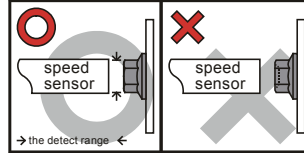

The hexagon screw
The best detection area: The middle of the screws.

⚠ Some hexagon screw centers have a small hole in this case, we suggest you to obtain the signal from the edge of the screw like the hexagon socket screw.

EX. 2,4

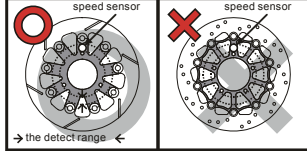

The disc
The best detection area: Detect the speed signal from the gaps of the disc.

⚠ Note that there are discs with the gaps in different locations, so this method may not work.

EX. 3

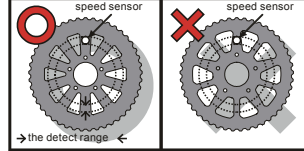

The sprocket
The best detection area: Detect the speed signal from the gaps of the sprocket.

⚠ Note that there are sprockets with the gaps in different locations, so this method may not work.

3-1 Meter Size

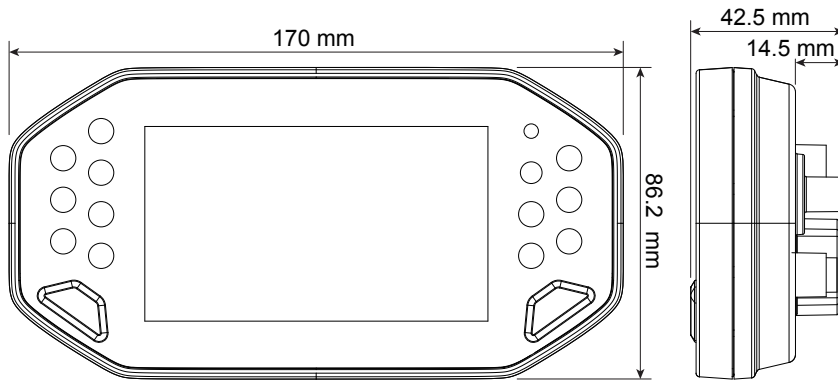

3-2 Basic Function Instructions

Tachometer

- Display range : 0~10,000 RPM
- 0~12,500 RPM
- 0~15,000 RPM
- 0~18,000 RPM

Clock

- Display range : 00:00 ~ 23:59 (24H), 1:00 ~ 12:59 (12H)

Phone battery

- Display range : 3 segments.
- Bluetooth® connection status**
- Display range : Steady (connected), OFF (Unconnected)

Fuel meter

- Display range : 6 levels
- Fuel warning**
- Display unit : 1 level (16.6 %)
- Display range : The warning value for low fuel shall be 1 segment and below, the warning signal will blink.

Indicator

- ABS light (Amber)
- Left indicator light (Green)
- Check engine light (Amber)
- Neutral light (Green)
- Composite warning light (Red)
- High beam light (Blue)
- Right indicator light (Green)
- Motor oil maintenance light (Red)

Gear Meter

- Display range : -, N, 1 ~ 6

Speedometer

- Display range : 0 ~ 360 km/h (0 ~ 225 MPH)
- Display unit : 1 km/h (MPH) Switchable











- Voltmeter**
- Display range : DC 8.0 ~ 18.0 V
 - Display unit : DC 0.1 V

- Trip meter A,B**
- Display range : 0.0~9,999.9 km (mile), may return to zero manually
 - Display unit : 0.1 km (mile)
 - Temperature A,B**
 - Display range : 0.0 ~ 250.0 °C (32.0 ~ 482.0 °F)
 - Display unit : 0.1 °C (°F)

- Odometer**
- Display range : 0~999,999 km (mile) and then return to zero
 - Display unit : 1 km (mile)

3-3 Specifications(Meter)

●Speedometer	Display range : 0 ~ 360 km/h (0 ~ 225 MPH) Display unit : 1 km/h (MPH) Switchable
○Odometer	Display range : 0 ~ 999,999 km (mile)and then return to zero Display unit : 1 km (mile)
○Trip meter A, B	Display range : 0.0~9,999.9 km (mile), may return to zero manually Setting unit : 0.1 km (mile)
○Motor oil maintenance	Setting range : 500 ~ 16,000 km(300~10,000 mile),OFF Setting unit : 100 km(mile)
○Speeding warning setting	Setting range : 30~360 km/h (20~225 MPH), when setting value is reach or above, warning light will illuminate. Setting unit : 1 km/h (MPH)
○Max. speed record	Display range : 0 ~ 360 km/h (0 ~ 225 MPH) Display unit : 1 km/h (MPH)
○Circumference	Setting range : 300~2,500 mm Setting unit : 1 mm
○Sensitive point	Setting range : 1~20 P Setting unit : 1 P
●Gear Meter	Display range : -, N, 1~the highest gear, (the highest gear shall be based on the gear learning)
○Max. Gear record	Display range : -, N, 1~the highest gear (the highest gear shall be based on the gear learning) , may return to zero manually.
●Tachometer	Display range : 0~10,000 RPM / 0~12,500 RPM / 0~15,000 RPM / 0~18,000 RPM
○Pre-shift light warning setting	Setting range : 1,000~10,000 RPM / 1,000~12,500 RPM / 1,000~15,000 RPM / 1,000~18,000 RPM Setting unit : 100 RPM
○Shift light warning setting	Setting range : 1,000~10,000 RPM / 1,000~12,500 RPM / 1,000~15,000 RPM / 1,000~18,000 RPM Setting unit : 100 RPM
○Max. rotating speed	Setting range : 0~10,000 RPM / 0~12,500 RPM / 0~15,000 RPM / 0~18,000 RPM ,may return to zero manually
○The RPM input signal number setting	Setting range : 0.5,1.0~24.0
○The RPM input pulse	Setting range : Low-Act, High-Act
●Thermometer A, B	Display range : 0.0 ~ 250.0 °C (32.0 ~ 482.0 °F) Display unit : 0.1 °C (°F)
○Overheat warning A, B setting	Setting range : 60 ~ 250 °C (140 ~ 482 °F), when setting value is reached , the color of the number turns to red and flashes. Setting unit : 1 °C (°F)
○Max. temperature A, B record	Display range : 0.0 ~ 250.0 °C (32.0 ~ 482.0 °F) , may return to zero manually Display unit : 0.1 °C (°F)
●A/F ratio meter	Display range : 12.1~17.5 Display unit : 0.1
●Fuel meter	Display range : 6 levels (0~100%) Display unit : 1 level(16.6 %)
○Fuel Gauge Resistance (Ω)	Setting range : 100 Ω, 250 Ω, 270 Ω,390 Ω, 510 Ω, 1200 Ω, SW, learning mode,OFF
○Fuel warning setting	Setting range : 0 ~ 3/6, when setting value is reached or below, warning light will illuminate. Setting unit : 1
●Clock	Setting range : 00:00~23:59 (24H) 01:00~12:59 (12H)
○Perpetual calendar	Display range (year) : 2021 ~ 2099 Display range(month) : 1 ~ 12 Display range(day) : 1 ~ 31 Display range(Week) : MON, TUE, WED, THU, FRI, SAT, SUN
●Voltmeter	Display range : DC 8.0 ~ 18.0 V Display unit : DC 0.1 V
○Low voltage warning	Setting range : DC 8.0~13.0 V, when setting value is below, the color of the number turns to red and flashes. Setting unit : DC 0.1 V

○High voltage warning	Setting range : DC 13.1~18.0 V, when setting value is above, the color of the number turns to red and flashes. Setting unit : DC 0.1 V
●Target speed	Setting range : 30 ~ 360 km/h (20 ~ 225 MPH) Setting unit : 5 km/h (MPH)
●Target distance	Setting range : 50 ~ 1,500 m (1/32 ~ 30/32 mile) Setting unit : 50 m (1/32 mile)
●Top speed	Display range Speed : 0 ~ 360 km/h (0 ~ 225 MPH) Distance : 0 ~ 999 m (0~3,280 feet) Rotating speed : 0 ~ 10,000 RPM / 0 ~ 12,500 RPM / 0~15,000 RPM / 0 ~ 18,000 RPM Time : 0 ~ 9 : 59'99
●Record order	Setting range : Sequence, Best.
●Bluetooth® connection status	Operating system iOS : iOS 5.0 and above Android : Android 9 and above
●Phone battery	Display range: 3 segments
●Incoming phone call notice	Display range: Display name or number for up to 12 letters; "... " is displayed for more than 12 letters; "Unknown" is displayed when there is no name iOS - Display either name or number of the incoming call Android - Display number only
●Incoming online app call notice	Display range: Display name for up to 12 letters; "... " is displayed for more than 12 letters; "Unknown" is displayed when there is no name App supported: LINE, WeChat, WhatsApp iOS supported, Android not supported.
●Music playing message	Song name : 15 letters, and "... " is displayed when > 15 letters Artist name : 18 letters, and "... " is displayed when > 18 letters Total length of the music : 00:00 ~ 9:59:59 (iOS supported, Android not supported). Current playing time : 00:00 ~ 9:59:59 (iOS supported, Android not supported).
●Push notification	Display range: Name - 4 letters, "... " is displayed when > 4 letters Content -17 letters, "... " is displayed when > 17 letters Support iOS, not Android.
●Background display	Setting range : Auto(automatically switch according to the light : day mode display for a bright environment and Night mode display for a dark environment), Day mode, Night mode.
○Back light brightness (Day)	Setting range : 1/5(Darkest)~ 5/5(Brightest) Setting unit : 1/5
○Back light brightness (Night)	Setting range : 1/5(Darkest) ~ 5/5(Brightest),need ≤ the setting value of backlight brightness (day). Setting unit : 1/5
○Back light color	Setting range : blue, green, orange, white
●Unit	Speed unit : km/h , MPH Temperature unit : °C (Celsius) and °F (Fahrenheit)
●Voltage	DC 12 V
●Operating temperature	-20~ 85 °C
○Storage temperature	-30~ 90 °C
●Specification	JIS D 0203 (S2)
●Meter Size	170 x 86.2 x 42.5 mm
●Meter Weight	Around 246.0 g
●Indicator	ABS light (Amber)  Left indicator light(Green)  Check engine light (Amber)  Neutral light (Green)  Composite warning light (Red)  High beam light (Blue)  Right indicator light(Green)  Motor oil maintenance light (Red) 

NOTE Design and specifications are subject to change without notice.

4-1 Start screen for Initial Use

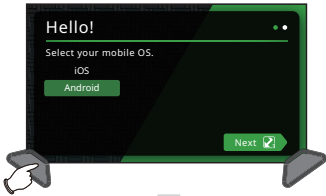

- Start screen for Initial Use, press the **Adjust or Select** button to choose mobile operating system.

NOTE Press the left button for explanation in the graphics.

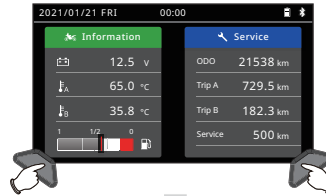

- Vehicle condition screen.
- Press the **Adjust + Select** buttons, to enter the main screen.

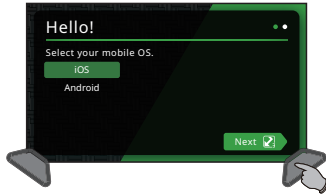

- Press the **Adjust button for 3 seconds**, enter the Bluetooth® pairing screen.
- EX : Select iOS for mobile phone operating system

NOTE **iOS operating system:**
iOS 5.0 and above
Android operating system:
Android 9 and above

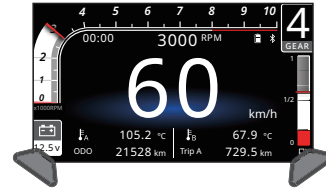

- The main screen.

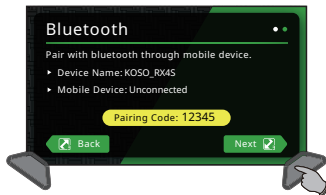

- Press the **Adjust button for 3 seconds**, enter the vehicle type screen.
- EX : Bluetooth® pairing screen completed.

NOTE **iOS operating system:**
Need to enter the pairing code.
Android operating system:
No pairing code is required.
Enter vehicle type selection directly.

4-2 Switching Instruction for Vehicle Condition Screen

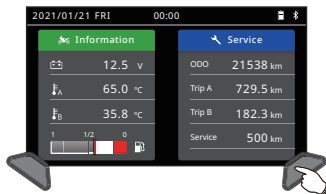

- In the Vehicle condition screen, press the **Adjust** button, to enter the Maintenance mileage screen (Flash).

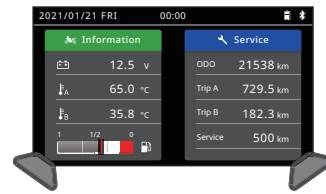

- The Vehicle condition screen.

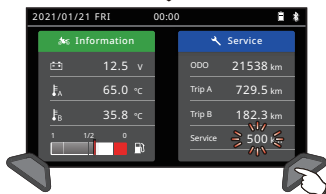

- In the Maintenance mileage screen (Flash), press the **Adjust** button to enter the Vehicle condition screen.
- Press the **Adjust button for 3 seconds** to reset Maintenance mileage screen.

4-3 Main Menu Switching Description(Adjust button)



- In the Trip A screen, press the **Adjust** button to enter the Trip B screen.
- Press the **Adjust button for 3 seconds** to reset Trip A record.

Trip A 1688.9 km → Trip A 0 km



- In the Max. record screen, press the **Adjust** button to go back to the Trip A screen.

- Press the **Adjust button for 3 seconds** to reset Max. record.

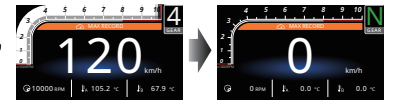

- In the Trip B screen, press the **Adjust** button to enter the Max. record screen.
- Press the **Adjust button for 3 seconds** to reset Trip B record.

Trip B 3055.5 km → Trip B 0 km



- In the Trip A screen.

4-4 Record Screen Switching Description(Target Speed, Target Distance, Top Speed)



- In the main screen, press the **Select + Adjust** buttons to enter the target speed record screen.



- In the top speed record screen, press the **Select + Adjust** buttons to go back to the main screen.



- In the target speed record screen, press the **Select** button to enter the target distance record screen.



- In the main screen.



- In the target distance record screen, press the **Select** button to enter the top speed record screen.

- Regardless of the record screen, press the **Select** button for 3 seconds to enter the Power Test setting.

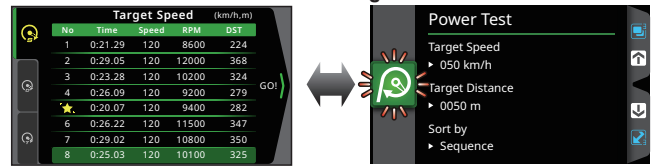

4-4-1 Description Of Target Speed Test



- In the target speed record screen, press the **Adjust** button to enter the testing screen.

NOTE Start the test when the bike is fully stopped.

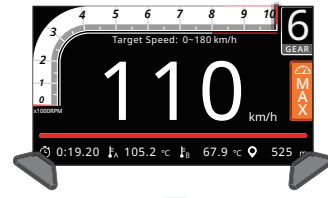

- When you reach the target speed that you set (0~110 km/h), the timer will stop (19"20 second).

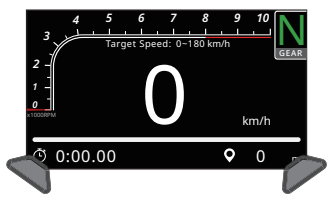

- In the testing screen.

WARNING! Use this function on racetracks to avoid accidents.

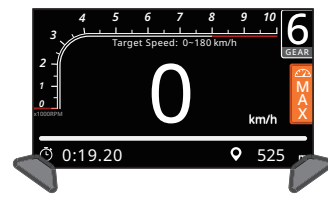

- When speed decreases to 0 km/h (MPH), the target speed record screen will appear.



- When the bike moves, the timer will start automatically.

NOTE The timer is automatic, so when your bike starts to move the timer will start to calculate the time and stop automatically when you stop the bike.



- In the target speed record screen.

- Press the **Adjust** button for 3 seconds, to reset the target speed record.



- Speed up.

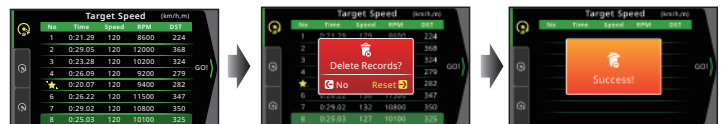

- Press the **Adjust** button to confirm deletion.
- Press the **Select** button to cancel deletion.

- Successfully deleted.
- The alert dialog will disappear after 3 seconds.

4-4-2 Description Of Target Distance Test



● In the target distance record screen, press the **Adjust** button to enter the testing screen.

NOTE Start the test when the bike is fully stopped.

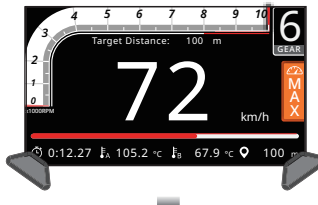

● When you reach the target distance that you set (100 M . 2/32 mile), the timer will stop (12'27 second).

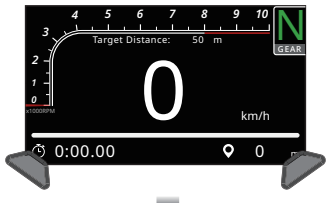

● In the testing screen.

WARNING! Use this function on racetracks to avoid accidents.

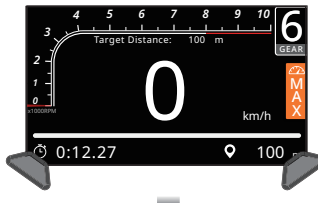

● When speed decreases to 0 km/h (MPH), the target distance record screen will appear.



● When the bike moves, the timer will start automatically.

NOTE The product adopts digital sensing; when the vehicle starts, the timer will immediately start measuring. Upon achieving the target distance, the timer will immediately stop measuring.



● In the target distance record screen.

● Press the **Adjust** button for 3 seconds, to reset the target distance record.

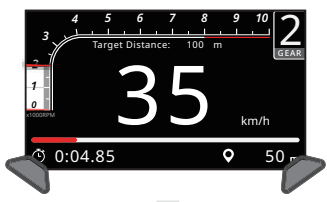

● Speed up.



● In the target distance record screen.

● Press the **Adjust** button for 3 seconds, to reset the target distance record.

4-4-3 Description Of Top Speed Test



● In the top speed record screen, press the **Adjust** button to enter the testing screen.

NOTE Start the test when the bike is fully stopped.

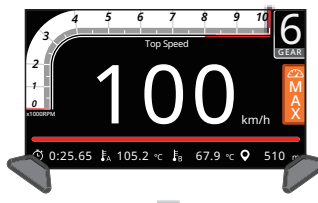

● When you reach the top speed (100 km/h), the meter will stop counting the distance (510 m), and time (25'65 seconds).

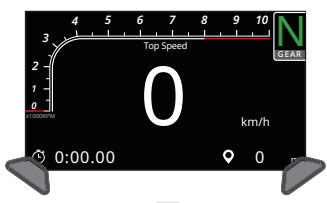

● In the testing screen.

WARNING! Use this function on racetracks to avoid accidents.

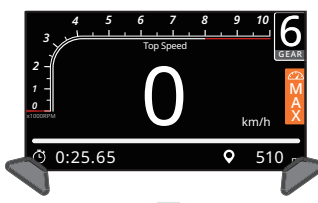

● When speed decreases to 0 km/h (MPH), the top speed record screen will appear.



● When the bike moves, the timer will start automatically.

NOTE Display range(Top speed) : Speed : 0 ~ 360 km/h (0 ~ 225 MPH)
Distance : 0 ~ 999 m (0~3,280 feet)
Rotating speed : 0 ~ 15,000 RPM
Time : 0 ~ 9'59'99



● In the top speed record screen.

● Press the **Adjust** button for 3 seconds, to reset the top speed record.

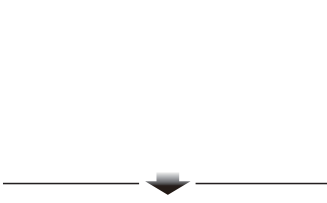

NOTE The product adopts digital sensing; when the vehicle starts, the odometer and the timer will immediately start measuring. Upon achieving the maximum speed, the odometer and the timer will immediately stop measuring.

△ To change the speed unit of the function go to 5-2(Change in Speed Unit).

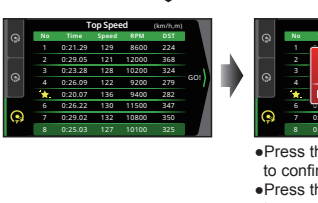

● In the top speed record screen.

● Press the **Adjust** button for 3 seconds, to reset the top speed record.



● Speed up.



● In the top speed record screen.

● Press the **Adjust** button for 3 seconds, to reset the top speed record.

5 Setting Screen Switching Description

- Press the **Adjust + Select** buttons for **3 seconds** on the main screen, record screen, or vehicle condition screen to switch to the setting screen.
- Press the **Select** button or **Adjust** button to select
 - 1 Date/Clock
 - 2 Unit(Speed/Temperature)
 - 3 Backlight(Mode/Brightness/Color)
 - 4 Speeding warning
 - 5 Shift light warning
 - 6 Overheat warning
 - 7 Voltage warning
 - 8 Fuel warning
 - 9 Motor oil maintenance
 - 10 ABS warning
 - 11 Warning light warning
 - 12 Tire circumference/Sensing point
 - 13 Gear
 - 14 RPM(Pulse / Signal / Range)
 - 15 Fuel resistance
 - 16 A/F ratio
 - 17 Power Test
 - 18 Internal and External ODO
 - 19 Meter information
 - 20 Bluetooth® and etc.
- Press the **Adjust** button for **3 seconds** to enter the setting function screen.
- In the setting screen, press the **Select** button for **3 seconds** to switch to the startup screen.

NOTE During setting, if any button is not pressed for 3 minutes, it will automatically return to the startup screen.

• Main screen



• Enter the setting screen.



1 Date/Clock

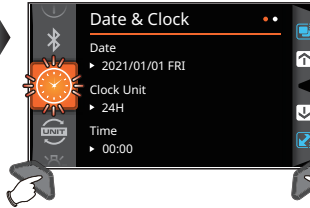

2 Unit(Speed/Temperature)

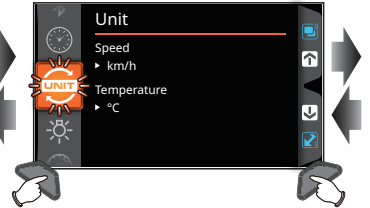

3 Backlight(Mode/Brightness/Color)



4 Speeding warning

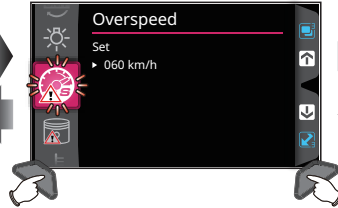

5 Shift light warning



6 Overheat warning

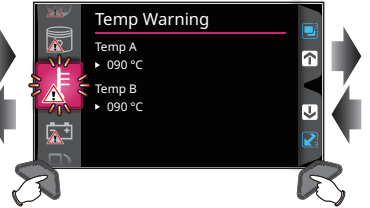

7 Voltage warning

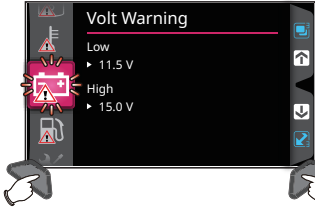

8 Fuel warning

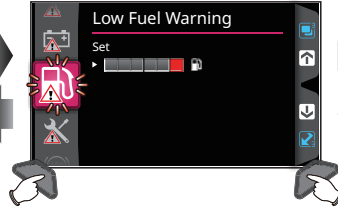

9 Motor oil maintenance



10 ABS warning

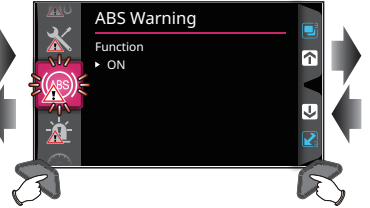

11 Warning light warning



12 Tire circumference/Sensing point

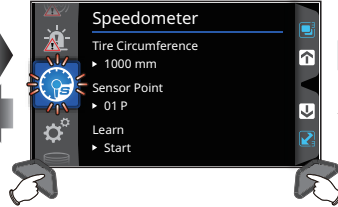

13 Gear



14 RPM(Pulse / Signal / Range)

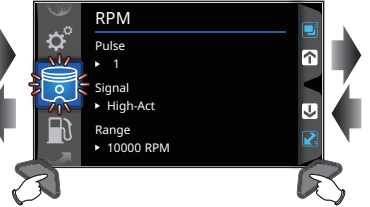

15 Fuel resistance

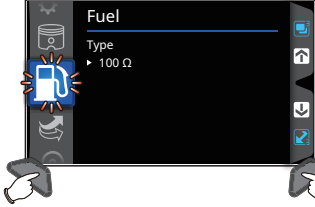

16 A/F ratio

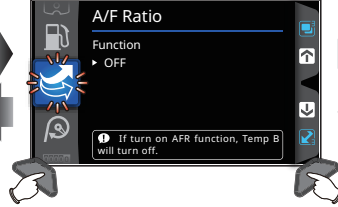

17 Power Test

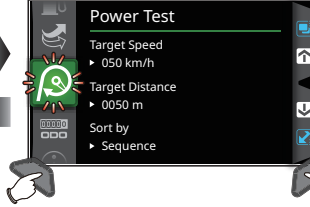

18 Internal and External ODO



19 Meter information

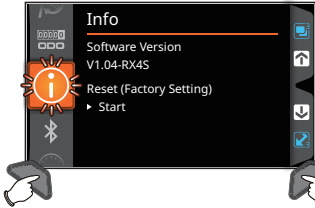

20 Bluetooth®

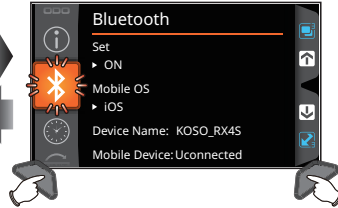

5-1 Date & Clock Setting

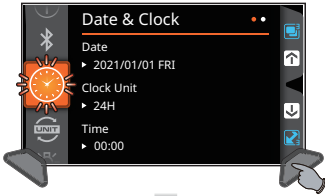

- The Date & Clock screen, press the **Adjust** button for 3 seconds to enter the Date & Clock setting.

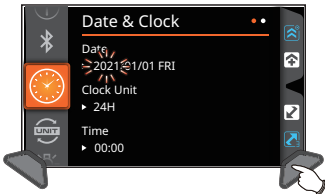

- **Example : To set the date to 2021.06.08.**
- Press the **Adjust** button to choose the setting options.

⚠ Now the setting value is flashing.

NOTE Setting range :
 (year) : 2021 ~ 2099
 (month) : 1 ~ 12
 (day) : 1 ~ 31
 (Week) : MON, TUE, WED,
 THU, FRI, SAT, SUN

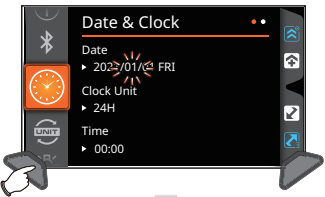

- Press the **Select** button to choose the setting number.

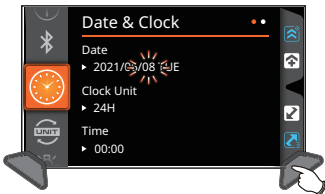

- EX : Set date from 2021.01.01 to 2021.06.08.
- Press the **Adjust** button to enter clock unit setting.



- **Example : Changing to 12H.**
- Press the **Select** button to choose the setting number.

⚠ Now the setting value is flashing.

NOTE Setting range : 12 H, 24 H.
 Default value : 24 H.

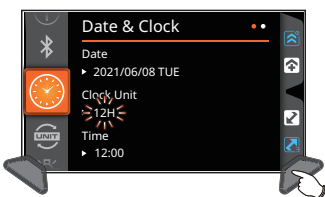

- EX : Set time format from 24 H to 12 H.
- Press the **Adjust** button to enter time adjustment hour setting.

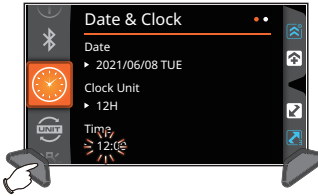

- **Example : To set clock(hour) to 10 hours.**
- Press the **Select** button to choose the setting number.

⚠ Now the setting value is flashing.

NOTE Cursor moving order is :
 Hour → Digit in ten minutes →
 Digit in minutes

NOTE Setting range : 1~12(12H)
 0 ~23(24H)
 Default value : 12(12H)/0(24H)

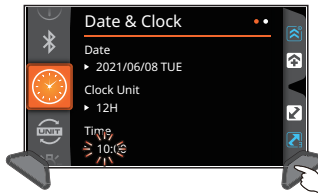

- EX : Set hour from 12:00 AM to 10:00 AM.
- Press the **Adjust** button to enter clock adjustment minute setting.

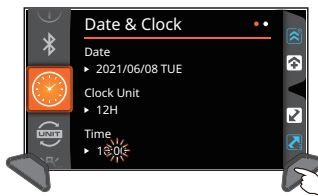

- Press the **Adjust** button to move to the digit you want to set.
- EX : To set clock(minute) as 10 minutes.

⚠ Now the setting value is flashing.

NOTE Setting range : 00~59 minutes.
 Default value : 0.

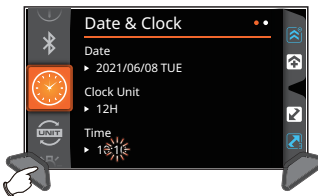

- Press the **Select** button to choose the setting number.

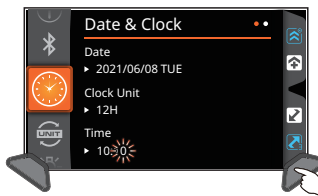

- EX : Set minute from 0 minutes to 10 minutes.
- Press the **Adjust** button to go back to the Date & Clock screen.

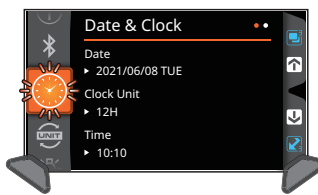

- The Date & Clock screen.

5-2 Unit (Speed, Temperature) Setting

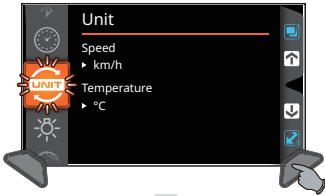

- The unit screen, press the **Adjust button for 3 seconds** to enter the speed unit setting.

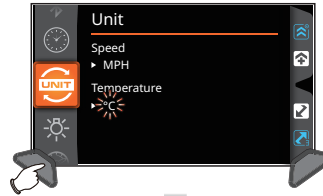

- Example : To set temp. unit to °F.**
- Press the **Select button** to choose the setting options.

⚠ Now the setting value is flashing.
NOTE Setting range : °C (Celsius) and °F (Fahrenheit).
 Default value : °C (Celsius).

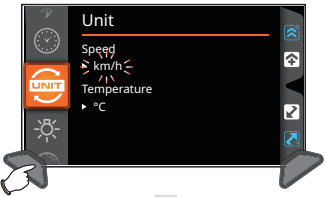

- Example : To set speed unit as MPH.**
 - Press the **Select button** to choose the setting options.
- ⚠ Now the setting value is flashing.
NOTE Setting range : km/h, MPH.
 Default value : km/h .

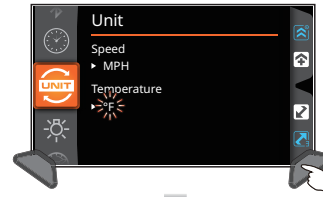

- EX : Set temp. unit from °C (Celsius) to °F (Fahrenheit).
- Press the **Adjust button** to go back to the unit (speed, temp.) screen.

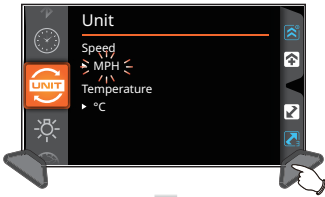

- EX : Set speed unit from km/h to MPH.
- Press the **Adjust button** to enter the temp. unit setting screen.

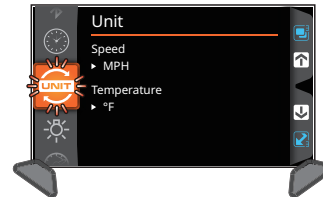

- The unit (speed, temp.) screen.

5-3 Backlight(Mode/Brightness/Color) Setting

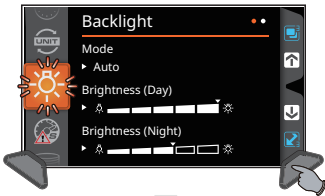

- The backlight screen, press the **Adjust button for 3 seconds** to enter the background mode setting.

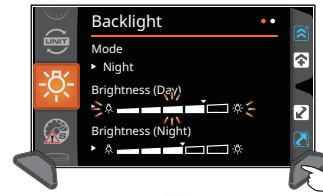

- EX : The backlight brightness (day) setting is changed from 5/5 (100%) to 4/5 (80%).
- Press the **Adjust button** to enter the backlight brightness (night) setting.

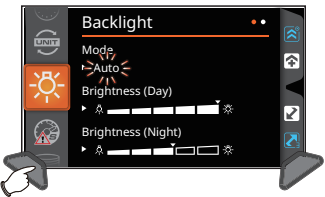

- Example : To set the gauge to Night mode.**
 - Press the **Select button** to choose the setting options.
- ⚠ Now the setting value is flashing.
NOTE Setting Auto(automatically switch according to the light : day mode display for a bright environment and Night mode display for a dark environment), Day mode, Night mode.
 Default value : Auto.

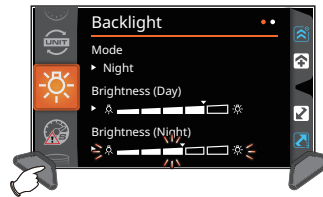

- Example : To set the backlight brightness (night) to 2/5(40%).**
- Press the **Select button** to choose the setting number.

⚠ Now the setting value is flashing.
NOTE Setting range : 1/5 (Darkest) ~ 5/5 (Brightest), need \leq the setting value of backlight brightness (day).
 Setting unit : 20% per level.
 Default value : 3/5(60%).

NOTE The backlight brightness will change immediately after you set the value.



- EX : Set background from Auto mode to Night mode.
- Press the **Adjust button** to enter the backlight brightness (day) setting.

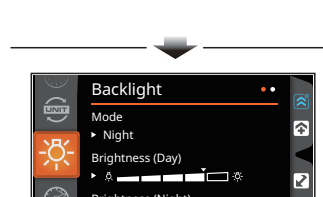

- EX : The backlight brightness (night) setting is changed from 3/5 (60%) to 2/5 (40%).
- Press the **Adjust button** to enter the backlight color setting.

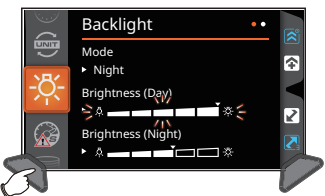

- Example : To set the backlight brightness (day) to 4/5(80%).**
 - Press the **Select button** to choose the setting number.
- ⚠ Now the setting value is flashing.
NOTE Setting range : 1/5 (Darkest)~ 5/5 (Brightest).
 Setting unit : 20% per level.
 Default value : 5/5(100%).
- NOTE** The backlight brightness will change immediately after you set the value.

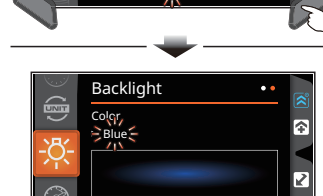

- Example : To set backlight color to white.**
- Press the **Select button** to choose the color .

⚠ Now the setting value is flashing.

NOTE Switch color according to the following order,blue, green, orange,white.

NOTE Default value : blue.

NOTE The backlight color will change immediately after you set the value.



- EX : Set backlight color from blue to white.
- Press the **Adjust button** to go back to the backlight screen.



- The backlight screen.

5-4 Speed warning Setting

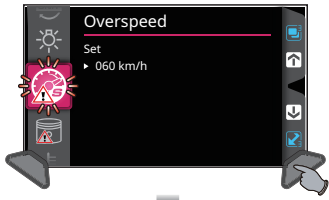

- The Speed warning screen, press the **Adjust button for 3 seconds** to enter the speed warning setting.

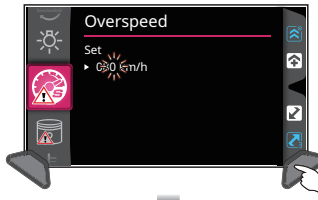

- EX : Set speed warning value from 60 km/h to 80 km/h.
- Press the **Adjust button** to go back to the speed warning screen.

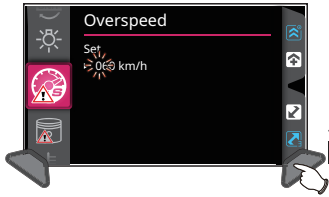

- Example** : To set speed warning value to 80 km/h.
- Press the **Adjust button** to move to the digit you want to set.

⚠ Now the setting value is flashing.

NOTE Setting range : 30~360 km/h (20~225 MPH).
Default value : 60 km/h (38 MPH).

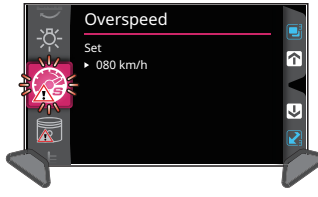

- The speed warning screen.

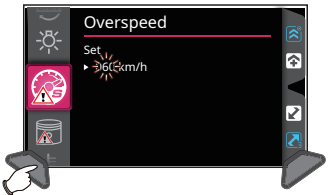

- Press the **Select button** to choose the setting number.

5-5 Shift light warning Setting

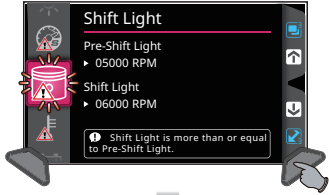

- The shift light warning screen, press the **Adjust button for 3 seconds** to enter the pre-shift light warning setting.



- Example** : To set shift light warning value to 10,000 RPM.
- Press the **Adjust button** to move to the digit you want to set.

⚠ Now the setting value is flashing.

NOTE Setting range : 1,000 ~ 10,000 RPM, need \geq the setting value of pre-shift light warning.
Default value : 6,000 RPM.

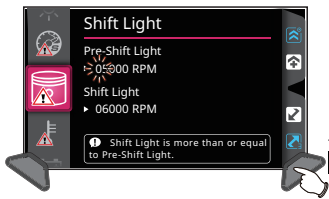

- Example** : To set pre-shift light warning value to 9,000 RPM.
- Press the **Adjust button** to move to the digit you want to set.

⚠ Now the setting value is flashing.

NOTE Setting range : 1,000 ~ 10,000 RPM
Default value : 5,000 RPM.



- Press the **Select button** to choose the setting number.

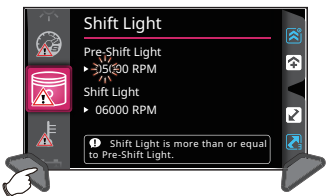

- Press the **Select button** to choose the setting number.

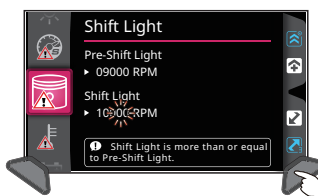

- EX : Set shift light warning value from 6,000 RPM to 10,000 RPM.
- Press the **Adjust button** to go back to the shift light warning screen.

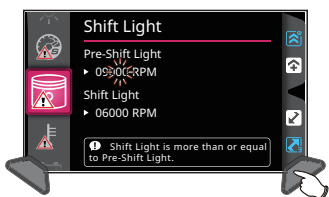

- EX : Set pre-shift light warning value from 5,000 RPM to 9,000 RPM.
- Press the **Adjust button** to enter the shift light warning setting.



- The shift light warning screen.

5-6 Overheat Warning Setting

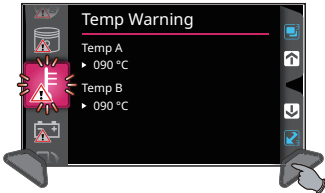

- The overheat warning screen, press the **Adjust** button for 3 seconds to enter the overheat warning A setting.

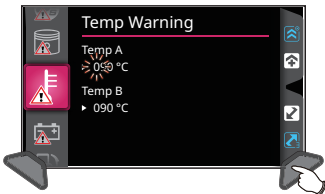

- Example** : To set overheat warning A value to 120 °C.
- Press the **Adjust** button to move to the digit you want to set.
- ⚠ Now the setting value is flashing.
- NOTE** Setting range : 60 ~250 °C (140 ~482 °F).
Default value : 90 °C(194 °F).

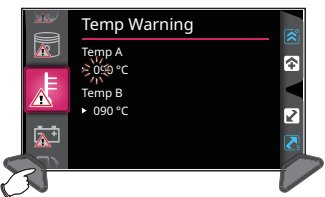

- Press the **Select** button to choose the setting number.

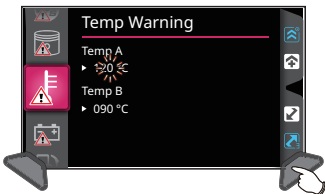

- EX : Set overheat warning A value from 90 °C to 120 °C.
- Press the **Adjust** button to enter the overheat warning B setting.

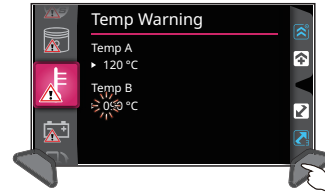

- Example** : To set overheat warning B value to 150 °C.
- Press the **Adjust** button to move to the digit you want to set.
- ⚠ Now the setting value is flashing.
- NOTE** Setting range : 60 ~250 °C (140 ~482 °F).
Default value : 90 °C(194 °F).

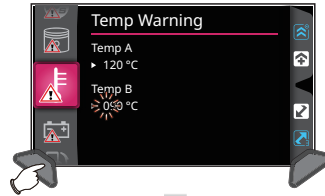

- Press the **Select** button to choose the setting number.

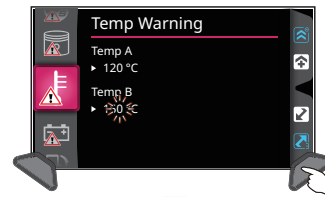

- EX : Set overheat warning B value from 90 °C to 150 °C.
- Press the **Adjust** button to go back to the overheat warning setting.

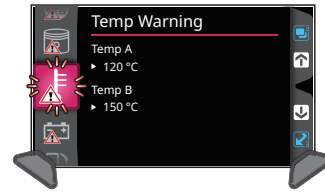

- The overheat warning screen.

5-7 Voltage warning Setting

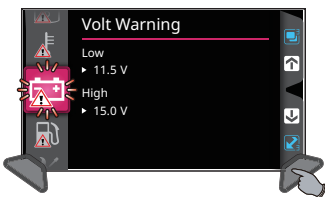

- The voltage warning screen, press the **Adjust** button for 3 seconds to enter the low voltage warning setting.

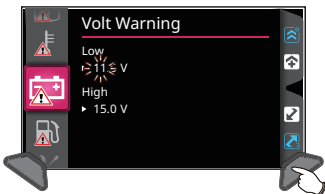

- Example** : To set low voltage warning value to DC 11.0 V.
- Press the **Adjust** button to move to the digit you want to set.
- ⚠ Now the setting value is flashing.
- NOTE** Setting range : DC 8.0~13.0 V.
Default value : DC 11.5 V.

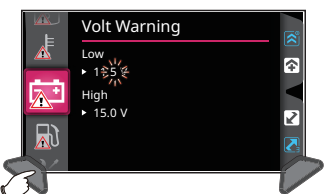

- Press the **Select** button to choose the setting number.

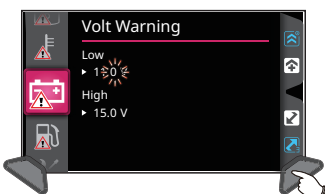

- EX : Set low voltage warning value from DC 11.5 V to DC 11.0 V.
- Press the **Adjust** button to enter the high voltage warning setting.

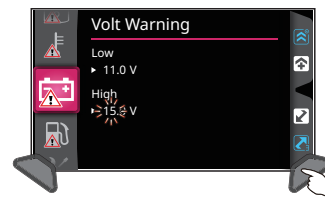

- Example** : To set high voltage warning value to DC 16.0 V.
- Press the **Adjust** button to move to the digit you want to set.
- ⚠ Now the setting value is flashing.
- NOTE** Setting range : DC 13.1~18.0 V.
Default value : DC 15.0 V.

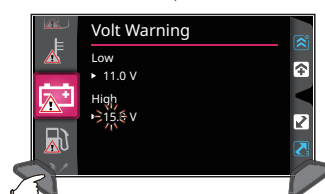

- Press the **Select** button to choose the setting number.

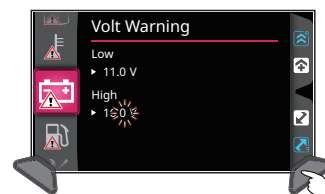

- EX : Set high voltage warning value from DC 15.0 V to DC 16.0 V.
- Press the **Adjust** button to go back to the voltage warning screen.

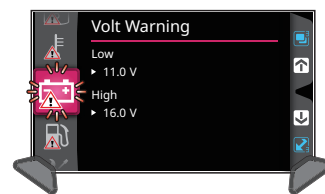

- The voltage warning screen.

5-8 Low Fuel Warning Setting

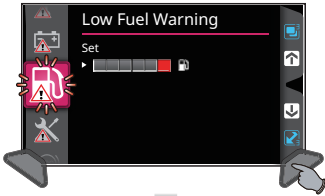

- The low fuel warning screen, press the **Adjust button for 3 seconds** to enter the low fuel warning setting.

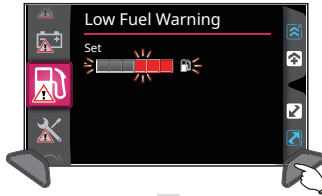

- EX : Set low fuel warning value from 1/6 to 3/6.
- Press the **Adjust button** to go back to the low fuel warning screen.

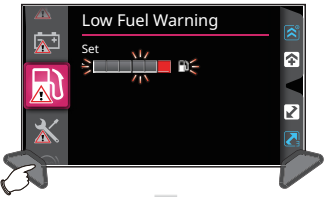

- Example : To set low fuel warning value to 3/6 .**
- Press the **Select button** to choose the setting number.
Now the setting value is flashing.

NOTE Setting range : 0/6 ~ 3/6.
Default value : 1/6.

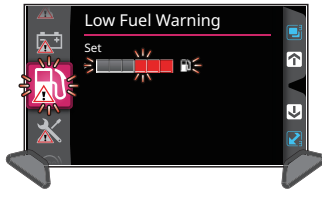

- The low fuel warning screen.

5-9 Maintenance mileage Setting

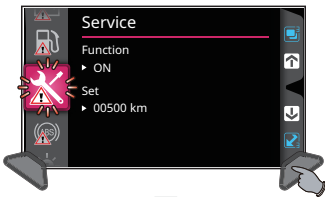

- The maintenance mileage screen, press the **Adjust button for 3 seconds** to enter the motor oil maintenance setting.

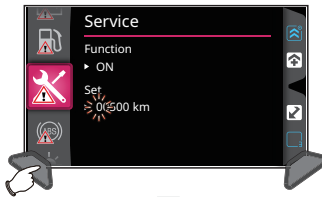

- Press the **Select button** to choose the setting number.

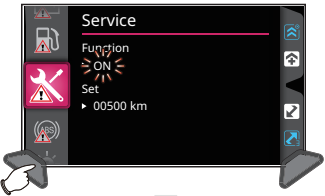

- Example : To set mileage maintenance to (ON).**
- Press the **Select button** to choose the setting number.
Now the setting value will blink.

NOTE Settings range : ON, OFF.
Default value : ON.

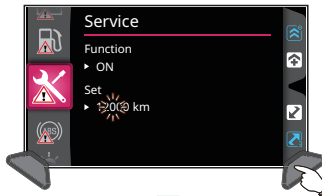

- EX : Set the mileage maintenance from 500 km to 12,000 km.
- Press the **Adjust button** to return to mileage maintenance main screen.

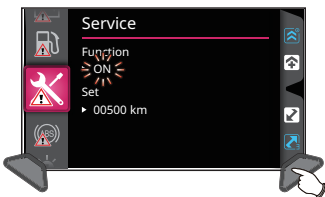

- EX : Set mileage maintenance to (ON).
- Press the **Adjust button** to enter into the mileage maintenance main screen.

NOTE When is set to OFF, will directly return to mileage maintenance main screen.

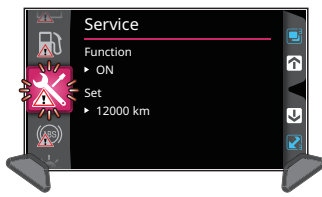

- The maintenance mileage screen.

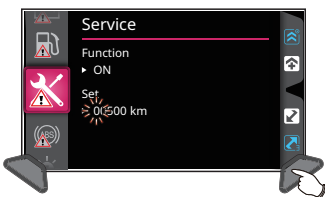

- Example : To set motor oil maintenance to 12,000 km.**
- Press the **Adjust button** to move to the digit you want to set.
Now the setting value is flashing.

NOTE Setting range : 500 ~ 16,000 km
(300~10,000 mile).
Default value : 500 km(300 mile).

5-10 ABS Warning Setting



- The ABS warning screen, press the **Adjust button for 3 seconds** to enter the ABS warning setting.

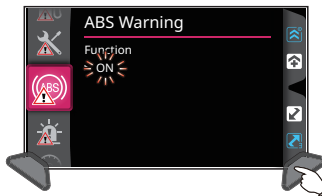

- EX : Set ABS warning to ON.
- Press the **Adjust button** to return to ABS warning setting main screen.

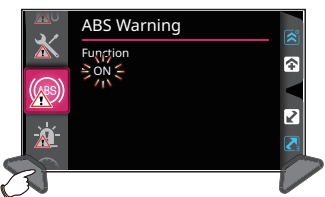

- Example : To set ABS warning value to ON .**
- Press the **Select button** to choose the setting number.
Now the setting value will blink.

NOTE Settings range : ON, OFF.
Default value : ON.

⚠ When choosing ON, the ABS signal light (ABS) will activate.

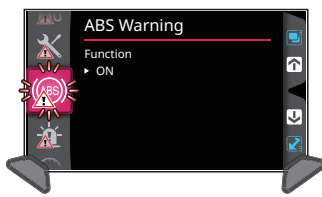

- The ABS warning screen.

5-11 Warning Light Setting



- The warning light screen, press the **Adjust button** for **3 seconds** to enter the warning light setting.

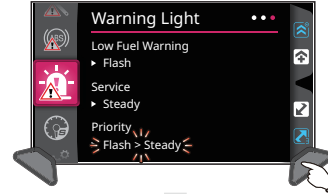

- Press the **Adjust button** to go back to the warning light screen.



- Press the **Select button** to choose the setting number.
- Press the **Adjust button** to confirm selection.

⚠ **Now the setting value is flashing.**

NOTE Setting range :
 OFF, Flash, Steady.
 Default value :
 1. Overspeed : OFF
 2. Pre-Shift Light : Flash
 3. Shift Light : Steady
 4. Temp A Warning : OFF
 5. Temp B Warning : OFF
 6. Volt Warning : OFF
 7. Low Fuel Warning : OFF
 8. Service : OFF



- The warning light screen.



NOTE Priority setting range :
 Steady > Flash / Flash > Steady

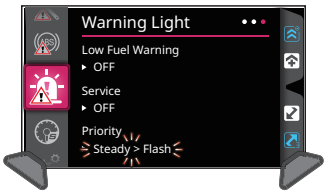

5-12 Tire Circumference and sensor point setting

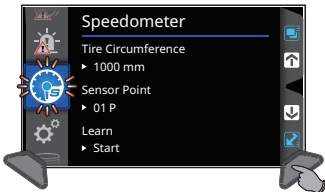

- The tire circumference and sensor point screen, press the **Adjust button** for **3 seconds** to enter the tire circumference and sensor point setting.

⚠ **CAUTION!**

- Measure the tire circumference (The tire you will install the sensor on) and confirm the number of sensor points.
- The speed displayed on the meter will be affected by the setting, make sure the setting number is correct before you enter the setting.

⚠ Reset this setting value if you change to a different tire size.

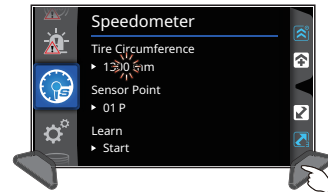

- EX : Set the tire circumference value from 1,000 mm to 1,300 mm .
- Press the **Adjust button** to enter the sensor point setting.

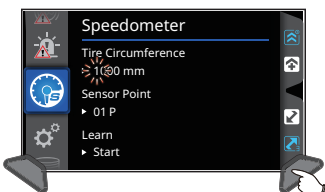

- **Example : If the tire circumference is 1,300 mm.**

- Press the **Adjust button** to choose the setting number.

⚠ **Now the setting value is flashing.**

NOTE Setting range : 300~2,500 mm.
 Default value : 1,000 mm.

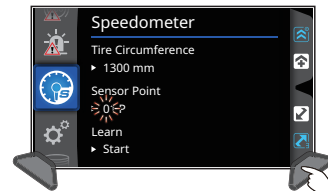

- **Example : To set the sensor point value to 06 P .**
- Press the **Adjust button** to move to the digit you want to set.

⚠ **Now the setting value is flashing.**

NOTE Setting range : 01 P~20 P.
 Default value : 01 P.

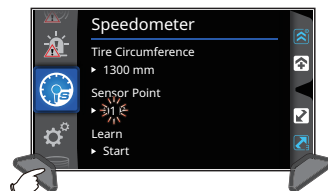
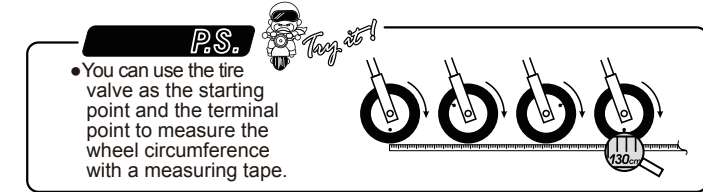

- Press the **Select button** to choose the setting number.

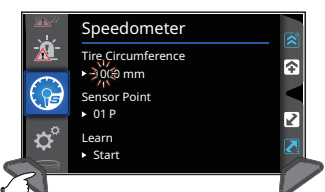

- Press the **Select button** to choose the setting number.

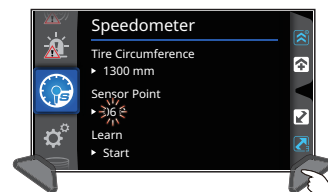

- EX : Set the sensor point value from 01 P to 06 P .
- Press the **Adjust button** to enter the learning mode setting.

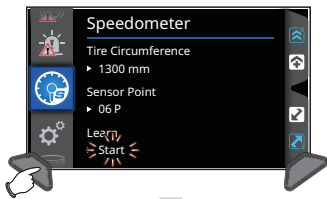

- Press the **Select** button to start the learning mode.

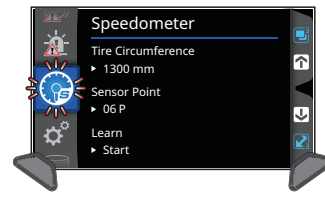

- The tire circumference and sensor point screen.

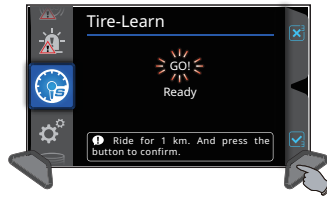

- Ride for 1 km (1 mile); after stopping, press the **Adjust** button for 3 seconds. Complete learning by returning to the tire circumference and sensor point screen.

- Press the **Select** button for 3 seconds to cancel learning.

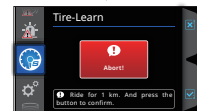

NOTE When the unit is set to miles, ride for 1 mile.

5-13 Gear Setting

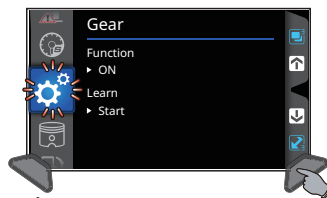

- The gear screen, press the **Adjust** button for 3 seconds to enter the gear setting.



- Example : You want to set the gear setting to ON.
- Press the **Select** button to choose the setting options.

⚠ Now the setting value is flashing.

NOTE Setting range : ON, OFF. Default value : ON.

NOTE Select OFF to return to the gear screen.



- EX : Set the gear setting to ON.
- Press the **Adjust** button to enter the gear-learning setting screen.

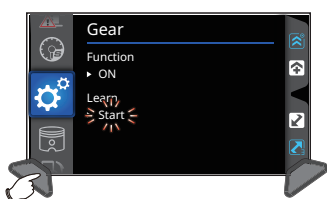

- Press the **Select** button to start the gear-learning setting.

NOTE Enter the Learning Mode, and learn the Gear position according to the speed and RPM.



- In the gear-learning setting.

CAUTION! Before setting, be sure to put your motor in Neutral to avoid error detection.

CAUTION! "Fail" on the screen means error detection, re-set Gear-Learn.

CAUTION! If gear learning is not required, press **Select** button and hold for 3 seconds to cancel the gear learning.

- When N→1 appears, change to Gear 1 to ride. When Gear 1 is detected, 1→2 appears and then change to Gear 2.



- 1 → 2 ○ Change to Gear 2.
- 2 → 3 ○ Change to Gear 3.
- 3 → 4 ○ Change to Gear 4.
- 4 → 5 ○ Change to Gear 5.
- 5 → 6 ○ Change to Gear 6.



- After reaching and finishing Gear 6, wait for a few seconds to end gear-learning and return to the gear screen.



- The gear screen.

5-14 RPM Input Pulse & Signal & Range

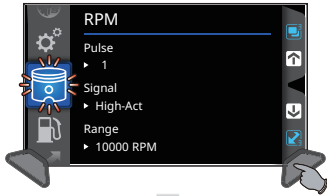

- The RPM input pulse, signal & Range screen, press the **Adjust** button for **3 seconds** to enter the RPM input pulse, signal & Range setting.

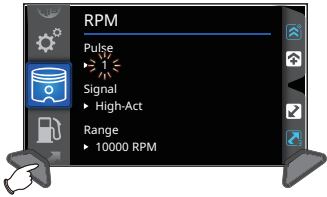

- Example** : You want to set the RPM input pulse to 2 (4 Stroke, 4 piston).
- Press the **Select** button to choose the setting number.

⚠ Now the setting value is flashing.

NOTE Setting range : P-0.5, 1.0~24.0.
Default value : 1.0.

The setting value	The corresponding stroke and pistons number.	The corresponding RPM signal number per ignition.
0.5	4C-1P	2 RPM signals per 1 ignition.
1.0	2C-1P 4C-2P	1 RPM signal per 1 ignition.
2.0	2C-2P 4C-4P	1 RPM signal per 2 ignition.
3.0	2C-3P 4C-6P	1 RPM signal per 3 ignition.
4.0	2C-4P 4C-8P	1 RPM signal per 4 ignition.
5.0	4C-10P	1 RPM signal per 5 ignition.
6.0	2C-6P 4C-12P	1 RPM signal per 6 ignition.

⚠ CAUTION!

Most of the 4-cycle bikes with one single piston are igniting once every 360 degree, so the setting should be the same as the bike with 2-cycle and one piston engine.

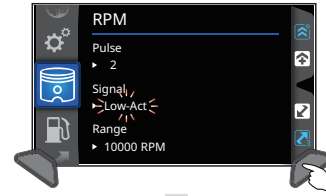

- EX : Set the signal from High-Act to Low-Act.
- Press the **Adjust** button to enter the RPM Range setting.

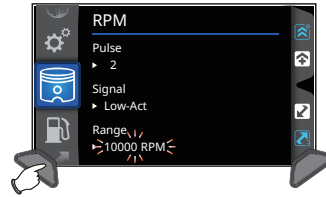

- Example** : Set the RPM Range to 15000 RPM.
- Press the **Select** button to choose the setting options.

⚠ Now the setting value is flashing.

NOTE Setting range : 10000 RPM, 12500 RPM, 15000 RPM, 18000 RPM.
Default value : 10000 RPM.

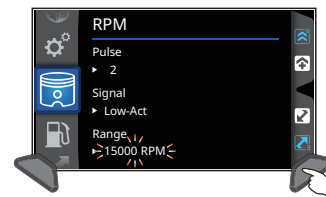

- EX : The RPM Range setting is changed from 10000 RPM to 15000 RPM.
- Press the **Adjust** button to go back to the RPM input pulse & Signal Impulse & Range screen.

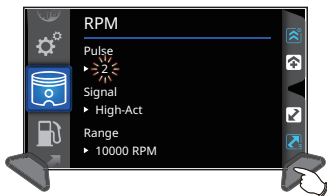

- EX : The RPM input pulse setting is changed from 1.0 to 2.0.
- Press the **Adjust** button to enter the signal impulse setting.

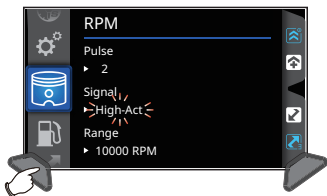

- Example** : Set the signal to Low-Act.
- Press the **Select** button to choose the setting options.

⚠ Now the setting value is flashing.

NOTE Setting range : High-Act, Low-Act.
Default value : High-Act.

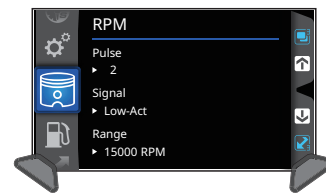

- The RPM input pulse, signal & Range screen.

5-15 Fuel Gauge Resistance Setting(Ω)

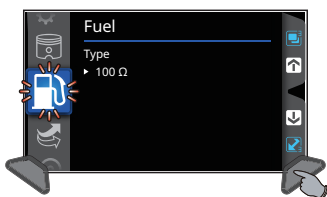

- The fuel gauge resistance screen, press the **Adjust** button for **3 seconds** to enter the fuel gauge resistance setting.

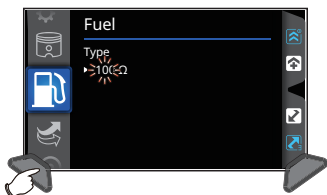

- Example**: If the vehicle is a YAMAHA T-MAX 530, it's resistance is 100 Ω according to the service manual.
- Press the **Select** button to choose the setting number.

⚠ Now the setting value is flashing.

NOTE Setting range : 100 Ω, 250 Ω, 270 Ω, 390 Ω, 510 Ω, 1200 Ω, SW, Custom, OFF.
Default value : 100 Ω.

NOTE Custom fuel level resistance:
1) Manual - Check 5-15-1 Fuel Level Resistance Manual Setting Instructions.
2) Auto - Check 5-15-2 Fuel Level Resistance Auto Setting Instructions.

NOTE If the fuel sensor wire is not plugged in, fuel level will display error.

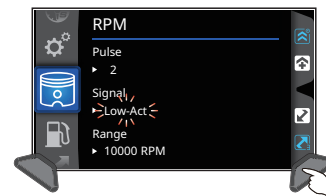

- EX : Set fuel gauge resistance value to 100 Ω.
- Press the **Adjust** button to go back to the fuel gauge resistance screen.

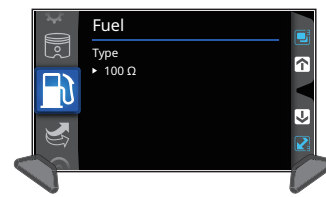

- The fuel gauge resistance screen.

5-15-1 Fuel Gauge Resistance Setting (Manual)

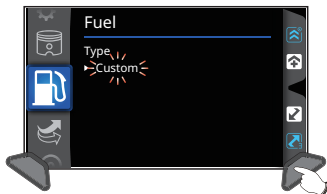

- Press the **Adjust** button to enter the fuel gauge resistance setting(manual).
- **Example** : For YAMAHA T-MAX 530, according to the service manual, the fuel tank resistance from low to high is 90 - 100 Ω (the lowest) and 4 - 10 Ω (the highest). So enter the setting value as 10 Ω .

P.S.



- You could find your fuel level sensor resistance range in the electronic components section in the service manual.
- Normally, we will recommend to choose the closest number set as the range to ensure that riders will not run out of gas before the fuel level indication. example, for YAMAHA T-MAX it's 90 - 100 Ω and 4 - 10 Ω , in which case we will suggest to use 90 - 10 Ω as the lowest and highest range.

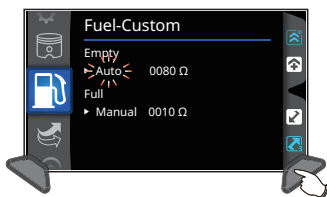

- **Example** : To set the lowest fuel level resistance value as 90 Ω .
- Press the **Adjust** button to move to the digit you want to set.
- ⚠ Now the setting value is flashing.

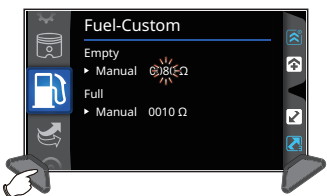

- Press the **Select** button to choose the setting number.

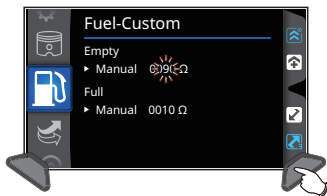

- EX : Set the lowest fuel level resistance value from 80 Ω to 90 Ω .
- Press the **Adjust** button twice to enter the highest fuel level resistance setting.

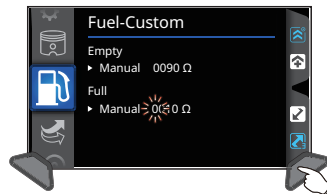

- **Example** : To set the highest fuel level resistance value as 10 Ω .
- Press the **Adjust** button to move to the digit you want to set.
- ⚠ Now the setting value is flashing.

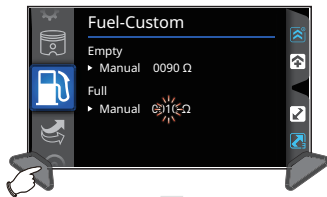

- Press the **Select** button to choose the setting number.

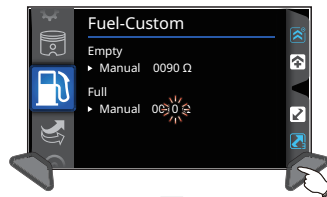

- EX : Set the highest fuel level resistance value to 10 Ω .
- Press the **Adjust** button to go back to the fuel gauge resistance screen.

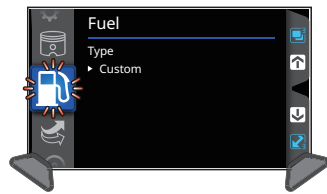

- The fuel gauge resistance screen.

5-15-2 Fuel Gauge Resistance Setting (Auto Detection)

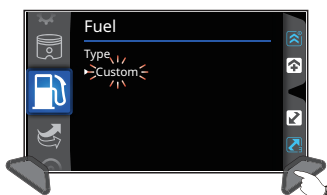

- Press the **Adjust** button to enter the fuel gauge resistance setting(auto detection).
- ⚠ **CAUTION!**
- Before detection, ensure that your current fuel level is in the lowest position that you would like to have.
- Stop the vehicle for a few seconds to allow the fuel surface to become steady, then start the detection of the resistance.

P.S.



- For example of YAMAHA T-MAX 530, if the fuel surface sensor float in the lowest position then press the **Select** button, it will detect the resistance around 90 Ω .

The lowest position

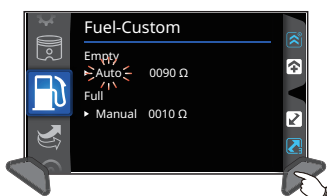

- EX : Auto Detection the lowest fuel level resistance value is 90 Ω .
- Press the **Adjust** button 5 times to enter the highest fuel level resistance auto detection screen.

P.S.



The highest position



- For example of YAMAHA T-MAX 530, if the fuel surface sensor float in the highest position then press the **Select** button, it will detect the resistance around 10 Ω .

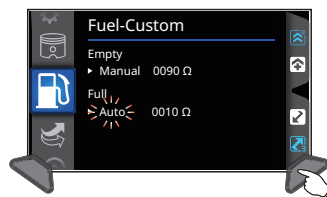

- EX : Auto Detection the highest fuel level resistance value is 10 Ω .
- Press the **Adjust** button to go back to the fuel gauge resistance screen.

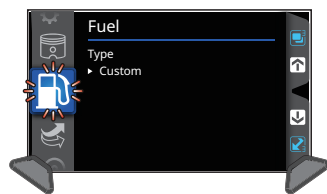

- The fuel gauge resistance screen.

5-16 A/F Ratio Setting

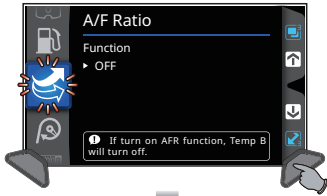

- The A/F ratio screen, press the **Adjust button for 3 seconds** to enter the A/F ratio setting.

NOTE To use the A/F ratio function, you will need to install related accessories and wiring.

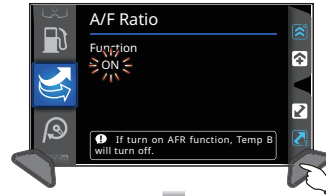

- Press the **Adjust button** to go back to the A/F ratio screen.

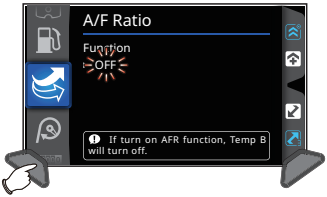

- Example : To set A/F ratio warning function to ON.**

- Press the **Select button** to choose the setting number.

⚠ Now the setting value is flashing.

NOTE Setting range : ON, OFF.
Default value : OFF.

- ⚠ If you activate AFR function, the Thermometer will auto turn off.

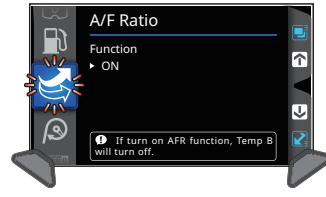

- The A/F ratio screen.

5-17 Power Test Setting

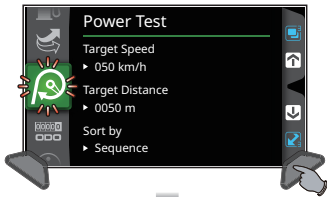

- The Power Test screen, press the **Adjust button for 3 seconds** to enter the Power Test setting.

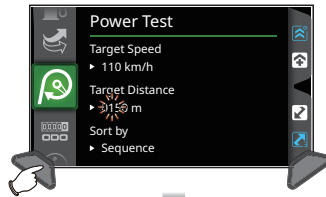

- Press the **Select button** to choose the setting number.

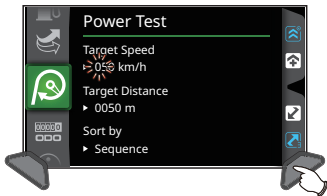

- Example : To set target speed value to 110 km/h.**

- Press the **Adjust button** to move to the digit you want to set.

⚠ Now the setting value is flashing.

NOTE Setting range : 30~360 km/h
(20~225 MPH).
Default value : 50 km/h (30 MPH).

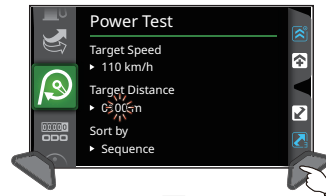

- EX : Set target distance value from 50 m to 100 m.
- Press the **Adjust button** to enter the the record order setting.

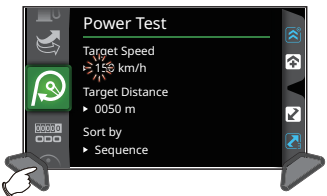

- Press the **Select button** to choose the setting number.

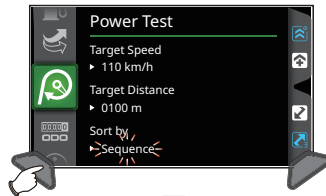

- Example : To set record order to Best.**
- Press the **Select button** to choose the setting options.

⚠ Now the setting value is flashing.

NOTE Setting range : Sequence, Best.
Default value : Sequence.

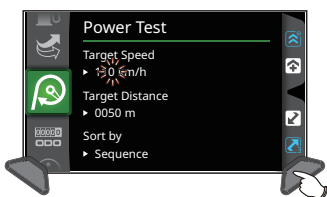

- EX : Set target speed value from 50 km/h to 110km/h.

- Press the **Adjust button** to enter the the target distance setting.

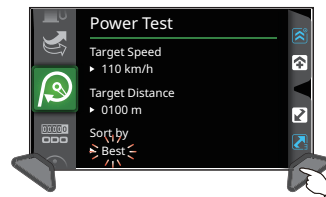

- EX : Set record order from Sequence to Best.
- Press the **Adjust button** to go back to the Power Test screen.

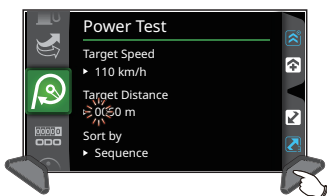

- Example : To set target distance value to 100 m.**

- Press the **Adjust button** to move to the digit you want to set.

⚠ Now the setting value is flashing.

NOTE Setting range : 50~1,500 m
(1/32~30/32 mile).
Default value : 50 m (1/32 mile).

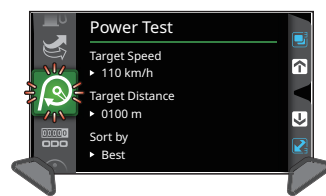

- The Power Test screen.

5-18 Internal and External ODO Setting

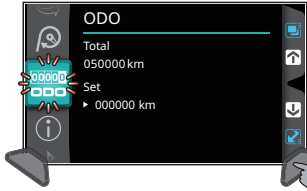

- The internal and external ODO screen, press the **Adjust button for 3 seconds** to enter the external ODO setting.

⚠ User unable to adjust or clear internal ODO.

NOTE Display range :0~999,999 km (mile).

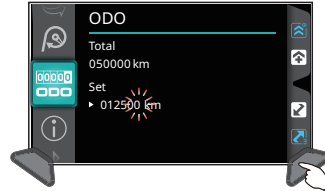

- EX : Set external total distance value from 000,000 km to 12,500 km.
- Press the **Adjust button** to go back to the internal and external ODO screen.

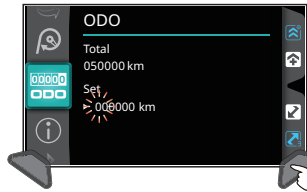

- Example : To set external total distance value to 12,500 km.**

- Press the **Adjust button** to move to the digit you want to set.

⚠ Now the setting value is flashing.

Cursor's order : one hundred thousand→ten thousands→thousand→hundred→ten→digit.

NOTE Setting range : 0 ~ 999,999 km (mile).

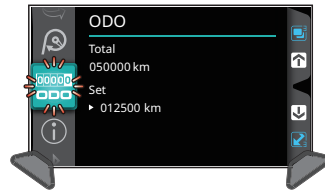

- The internal and external ODO screen.



- Press the **Select button** to choose the setting number.

5-19 Meter information Setting



- The meter information screen, press the **Adjust button for 3 seconds** to enter the meter information setting.

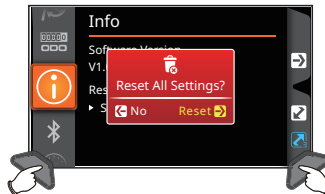

- Press the **Adjust button** to confirm reset.
- Press the **Select button** to cancel reset.



- Example : To reset the meter(original setting).**

- Press the **Select button** to reset.

⚠ Now the setting value is flashing.

NOTE User unable to adjust or clear software Version.

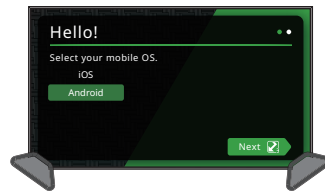

- Successfully reset and return to the boot screen for initial use.

5-20 Bluetooth® Setting



- The Bluetooth® screen, press the **Adjust button for 3 seconds** to enter the Bluetooth® setting.

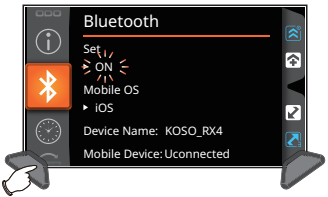

- Example : Select "ON" or "OFF" for the Bluetooth® setting.**
- Press the **Select button** to choose the setting options.
- If OFF is selected, then press the **Adjust button** to exit the Bluetooth® setting.
- If ON is selected, then press the **Adjust button** to enter the mobile operating system settings.

⚠ **Now the setting value is flashing!**

NOTE Setting range : ON, OFF.
Default value : ON.

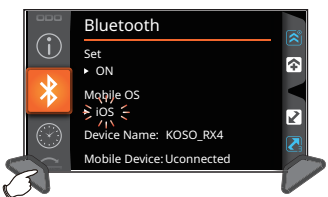

- Example : To set mobile operating system to iOS.**
- Press the **Select button** to choose the setting options.

⚠ **Now the setting value is flashing!**

NOTE Setting range : iOS, Android.
Supported version: iOS 5.0 and above, Android 9 and above.
Default value : iOS.

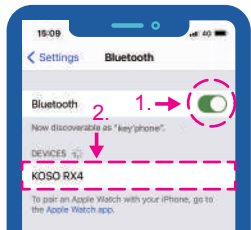

- Turn on the Bluetooth® function of the mobile phone.
- Press device "KOSO RX4."

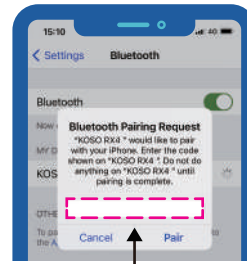

- Enter the code displayed on "KOSO RX4."

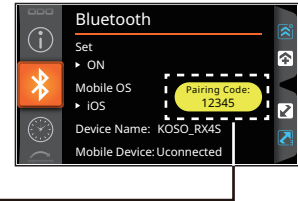

- Device successfully connected.

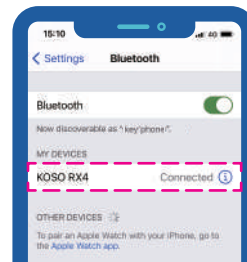

- EX : Bluetooth® successfully connected.
- Press the **Adjust button** to go back to the Bluetooth screen.

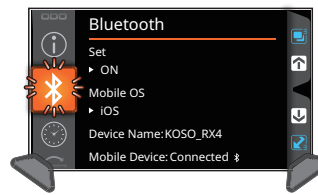

- The Bluetooth® screen.
- NOTE** After the Bluetooth® is successfully connected, the main screen may display the battery, incoming phone call notice, incoming online call notice, music playing message, information of the mobile phone.

Phone battery

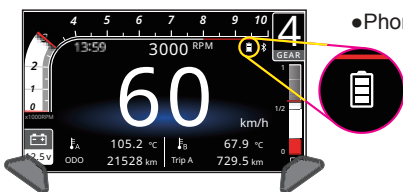

- Phone battery.

NOTE Display range : 3 bars.

Push notification

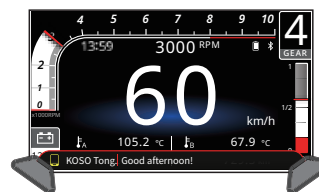

- Push notification screen.

NOTE Display range :
Name - 4 letters, and "... " is displayed for more than 4 letters.
Content - 17 letters, and "... " is displayed for more than 17 letters.
→ iOS supported, not Android.

Incoming phone call notice/ Incoming online call notice



- Incoming phone call notice screen.
- Incoming online call notice screen.

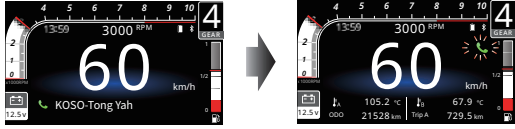

- Call connected screen.

NOTE ● Incoming phone call notice screen.

Display range : Display name or number for up to 12 letters; "... " is displayed if > 12 letters;
"Unknown" is displayed when there is no name
iOS - Display either name or number of the incoming call
Android - Display number only

● Incoming online call notice screen.

Display range : Display name for up to 12 letters;
"... " is displayed if >12 letters;
"Unknown" is displayed when there is no name
→ Support LINE, WeChat, WhatsApp
→ iOS supported, not Android.

Music playing info

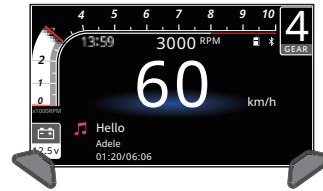

- Music playing info screen.

- NOTE** Song title: 15 letters, and "... " displayed if > 15 letters
Artist name: 18 letters, and "... " displayed > 18 letters
Total length of the song : 00:00 ~ 9:59:59,
"9:59:59" displayed if longer.
→ iOS supported, not Android.
Current playing time : 00:00 ~ 9:59:59,
"9:59:59" is displayed if longer.
→ Support iOS supported, not Android.

※ "The Company is committed to optimizing the Bluetooth® application function of the meter. However, as supports for software and hardware are different as mobile phones differ, the Bluetooth® application function of the meter may be affected, causing differences in functions."

6 Trouble Shooting

The following situations do not necessarily indicate malfunction of the product. Check the following points, before contacting us.

Trouble	Check item	Trouble	Check item
<p>The meter doesn't work when the power is on.</p> <p>The meter shows wrong information.</p> <p>Speed meter doesn't appear or appears incorrectly.</p> <p>Tachometer doesn't appear or appears incorrectly.</p> <p>Thermometer doesn't appear or appear incorrectly.</p>	<ul style="list-style-type: none"> ● The power isn't supplied to the meter. → Make sure the wiring is connected. The wiring and fuse are not broken. → The battery is too old to supply needed power (DC 12 V). ● Check the voltage of your battery, and make sure the voltage is over DC 12 V. ● May be poor connection of the speed sensor. → Check the speed sensor is connected correctly. ● Check the setting. → Refer to the manual 5-12 circumference and sensing point setting. ● Make sure the RPM wire is connected properly. → Check the RPM wire wire is connected correctly. ● Check the spark plug is R type or not. If not, replace the spark plug with the R type spark plug. ● Check the setting. → Refer to the manual 5-14 RPM input pulse, signal and Range. ● Make sure the temperature wire is connected properly. → Check the temperature wire is connected correctly. ● Check the setting. → Check whether it is set to the air-fuel ratio function. 	<p>A/F ratio doesn't appear or appears incorrectly.</p> <p>Fuel meter doesn't display or displays error.</p> <p>The clock is incorrect.</p> <p>Voltage doesn't appear or appears incorrectly. The meter indicator didn't display.</p>	<ul style="list-style-type: none"> ● Check the setting. → Refer to the manual 5-16 A/F ratio setting. ● Check your fuel tank. ● May be poor connection of the harness. → Make sure the wires are connected correctly. ● Check the setting. → Check the settings menu, the fuel settings are correct. ● Check the setting. → Check the settings menu, the clock settings are correct. ● May be due to the reversed power line. → Check the positive wire (Red) connects to the battery (DC 12 V), and main switch positive wiring (Brown) connects to the main switch (DC 12 V). ● May be due to poor connection of wiring. → Check whether the wires are disconnected or have fallen off. ● May be poor connection of the harness. → Make sure the wires are connected correctly.

※ If the problems still can't be solved, contact our technical department for assistance.

Android™ is a registered trademark of Google LLC. Apple® and iPhone® is a trademarks of Apple Inc., registered in the U.S. and other countries. The Bluetooth® word mark and logos are registered trademarks owned by Bluetooth SIG, Inc. and any use of such marks by Tong Yah Electronic Technology Co.,Ltd is under license. Other trademarks and trade names are those of their respective owners.