

SHAD

CFMOTO 700 CL-X '21- TOP MASTER C0CL71ST

BCN

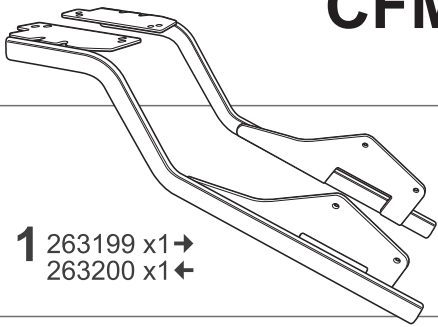

1 263199 x1 →
263200 x1 ←



2 261277 x8
Ø20 Ø11 x25



3 303045 x4
Ø8



4 303027 x4
Ø8

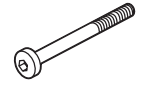

5 304173 x4
M8x75 DIN 7380

WARNING! ⚠

GB Do not fully tighten the screws until it is ensured that the KIT is correctly attached and aligned.

E No apretar los tornillos del todo hasta asegurarse que el KIT está correctamente colocado y alineado.

D Ziehen Sie die Schrauben nicht ganz fest, bevor Sie sich nicht vergewissert haben, daß der Bausatz korrekt eingestellt und ausgerichtet ist.

I Non stringere del tutto le viti fin tanto non si è sicuri che il kit è collocato correttamente e allineato.

F Ne pas serrer les vis avant d'être sûr que le KIT soit correctement positionné et ajusté.

ATTENTION: For a full equip assembly, mount the café racer after the top master.

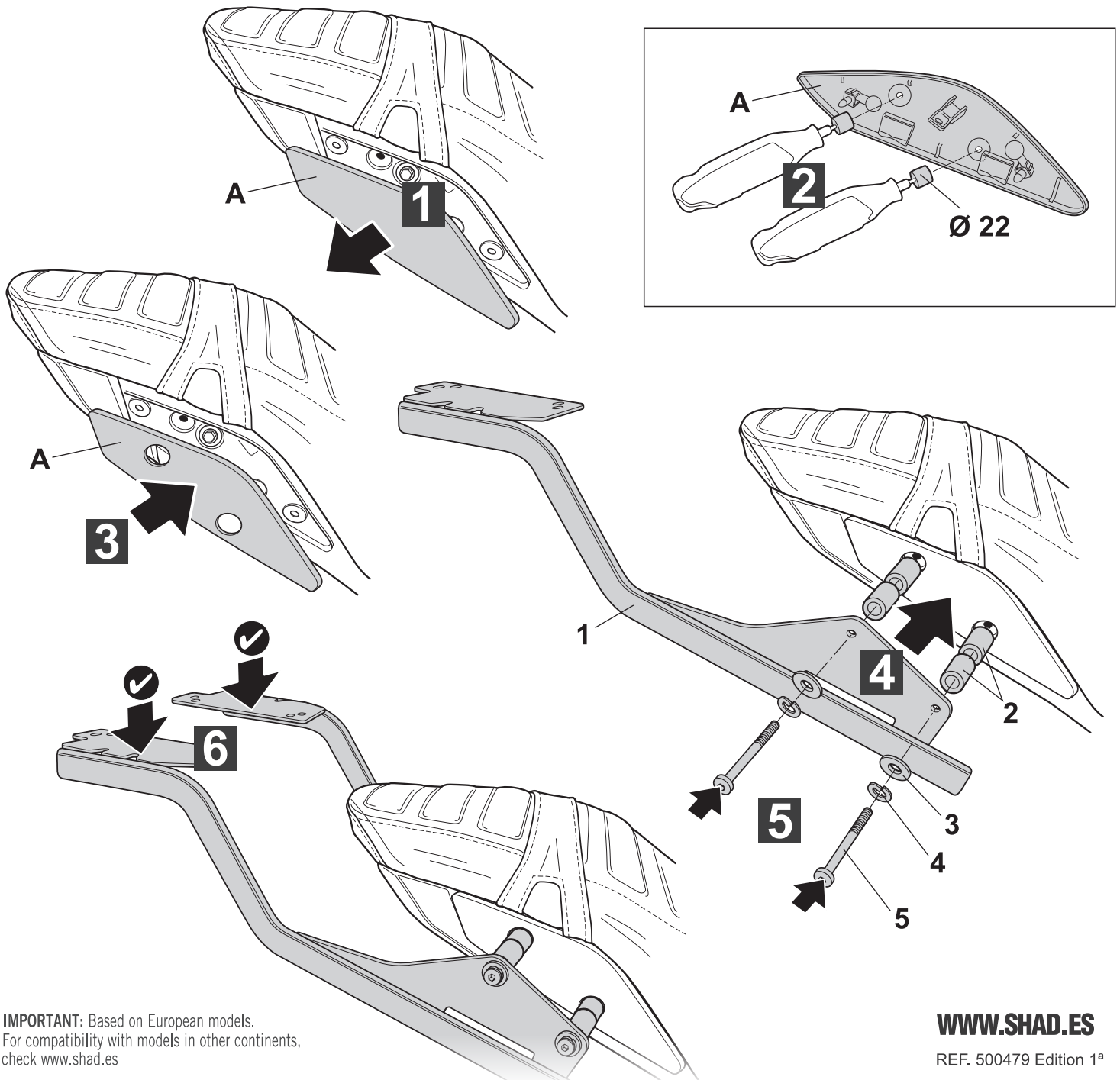

IMPORTANT: Based on European models.
For compatibility with models in other continents,
check www.shad.es

WWW.SHAD.ES

REF. 500479 Edition 1ª